

City Centre Transport Update

28th June 2023

Adam Crowther
Head of City Transport



General Update

- E-scooters – most well used scheme in UK, upward trajectory, tender out for e-scooter/e-bike operator (now announced as Tier)
- CAZ delivered and operational
- Buses
 - Challenging situation at present
 - Enhanced Partnership in place
 - Fare packages reducing costs, birthday package and others to come
 - WestLink in operation
- Lots of major developments approved with necessary transport mitigation
- Portway Rail Station built, Ashley Down Station started
- Redcliff Bridge and Gaol Ferry Bridge looking at late August/September for full reopening
- DDP



Strategic Corridors Programme Overview

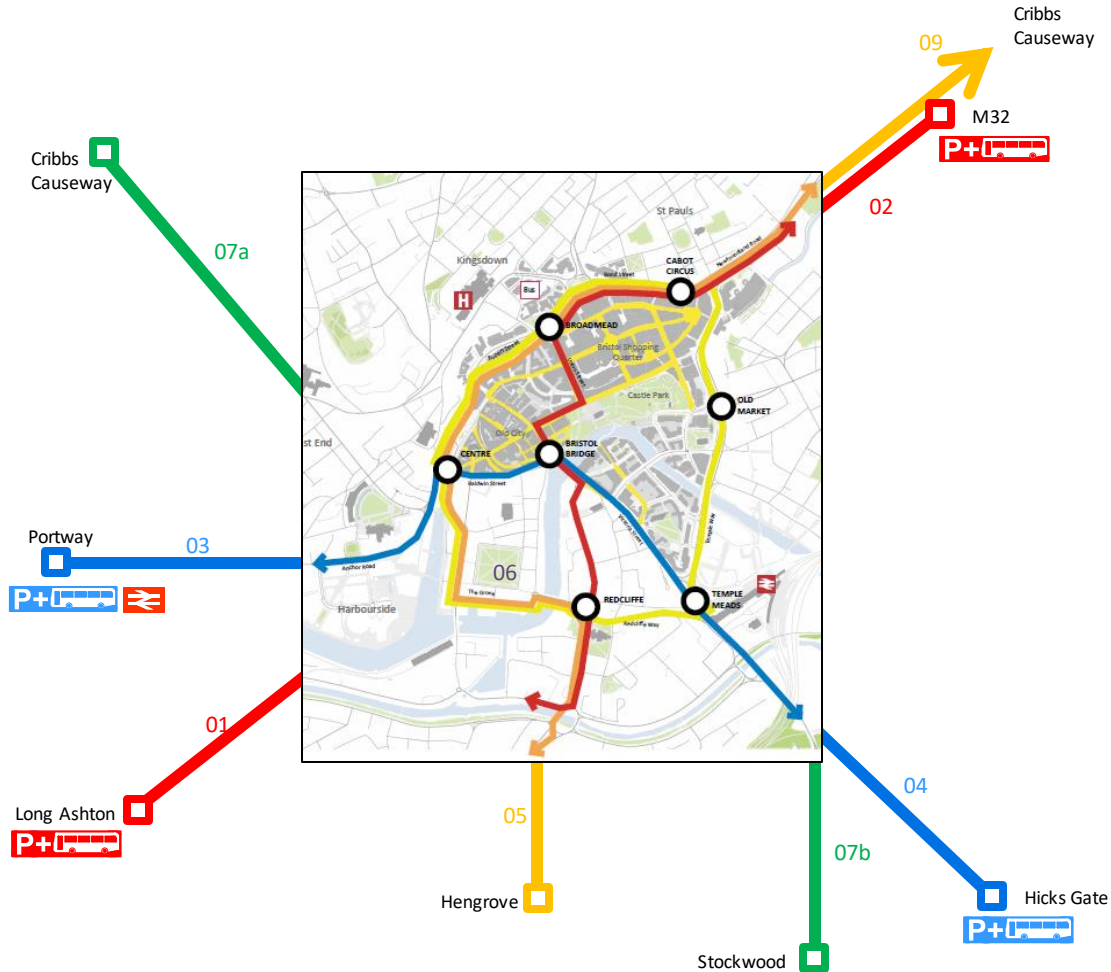

WECA Led Regional Projects

- M32 SOC under development for completion 2024
- A4 proposals being developed, engagement later this year



WP3 – A4 Portway

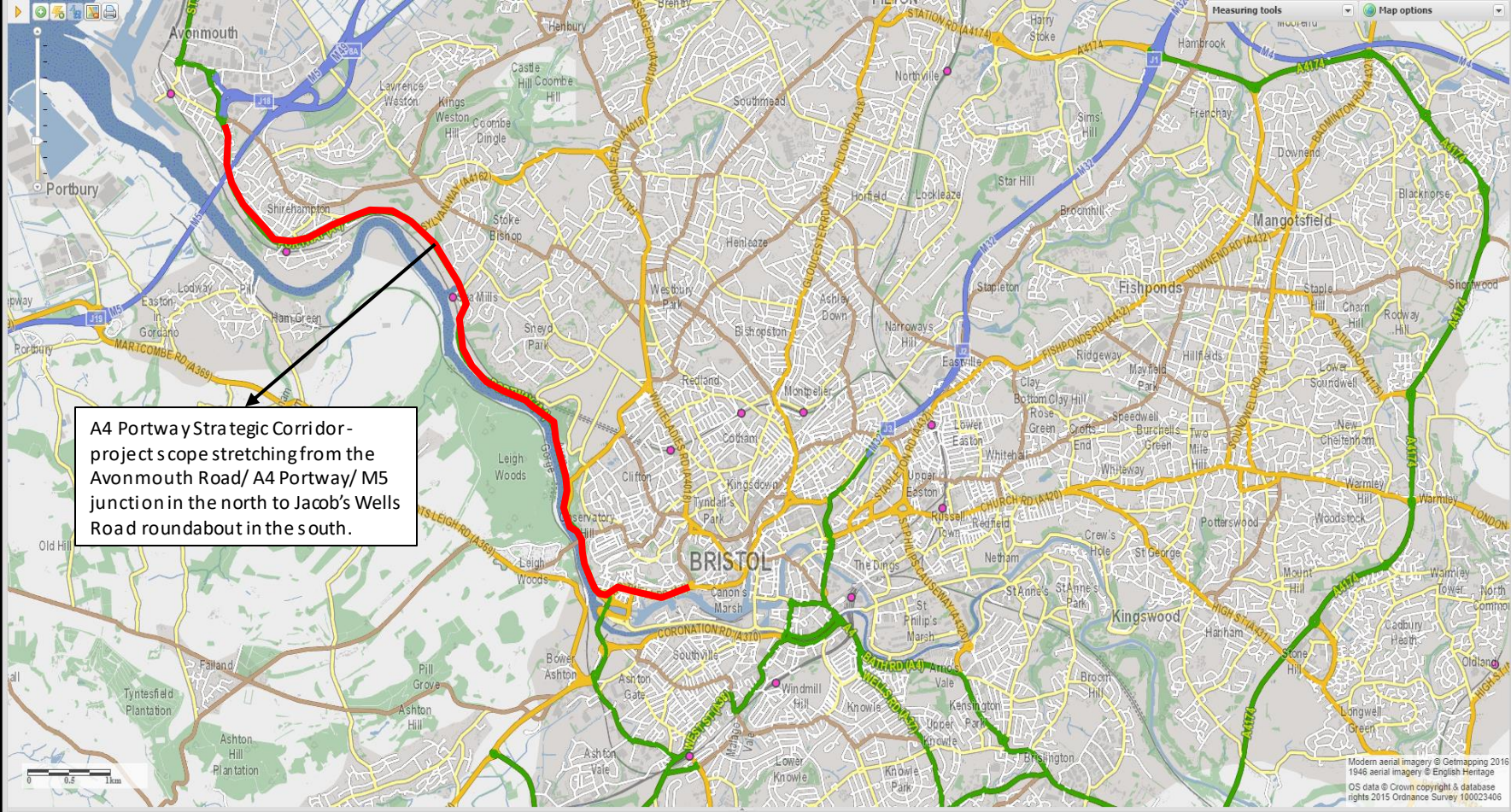

WP5 - A38 South metrobus Enhancements

- Bedminster Green – additional bus and cycle facilities as part of development
- Highway works commenced on site complete spring 2025
- River Restoration works to follow
- Hengrove Park junctions and cycle facilities
- Assessing options for extending routes through to Hartcliffe

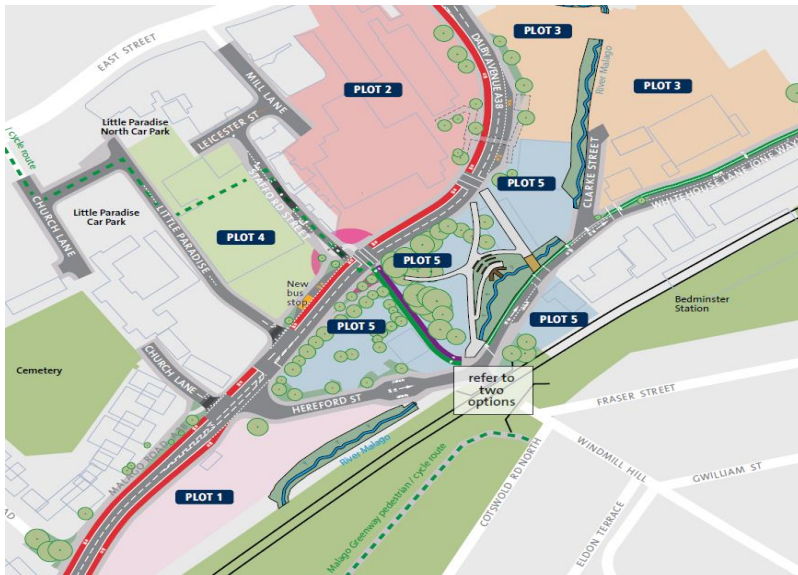

WP6 - City Centre

- High level strategy from City Centre Framework
- Options being tested to deliver aims
- Includes WP1 Long Ashton (Bedminster Bridges)

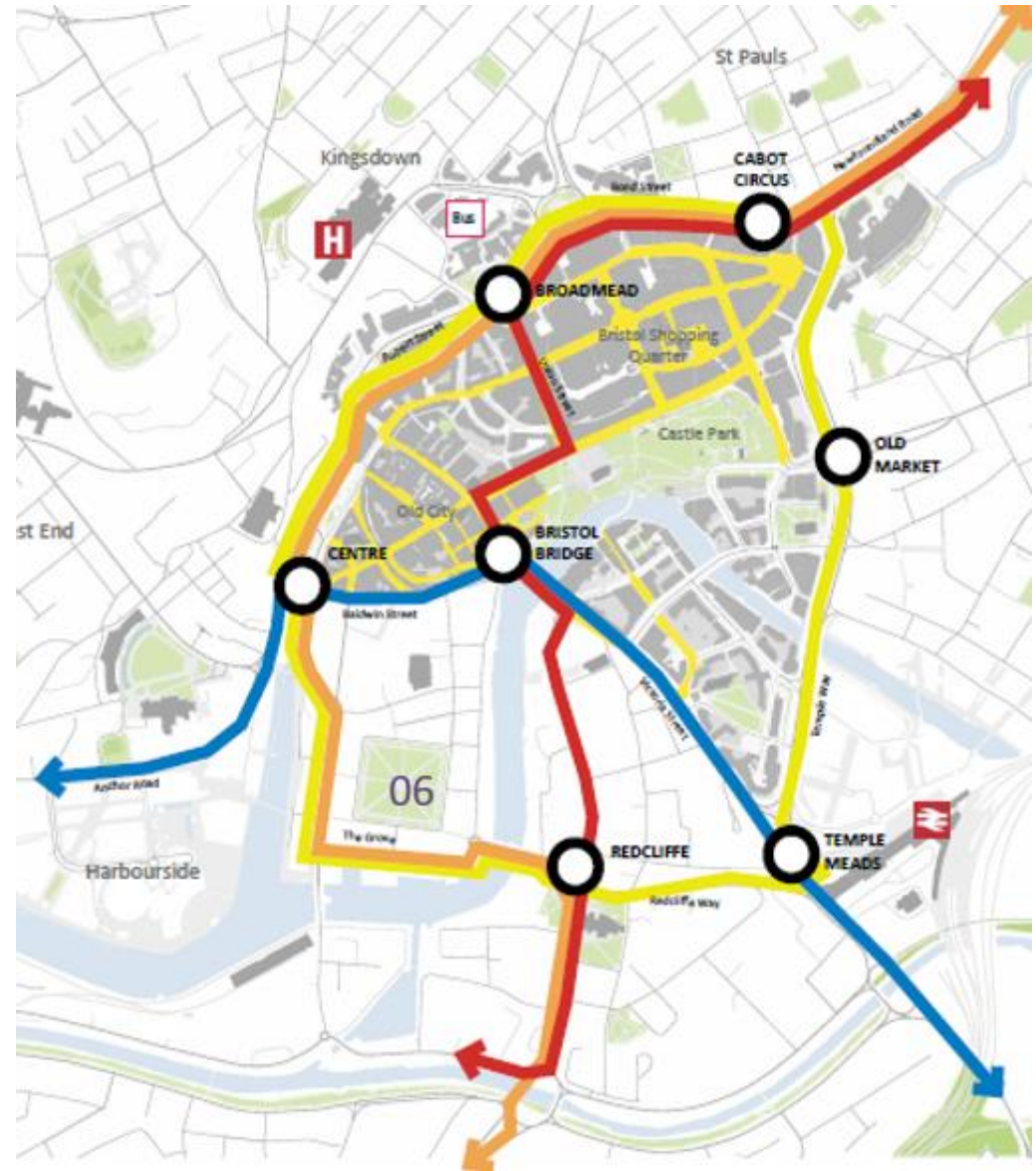

Bristol Bridge

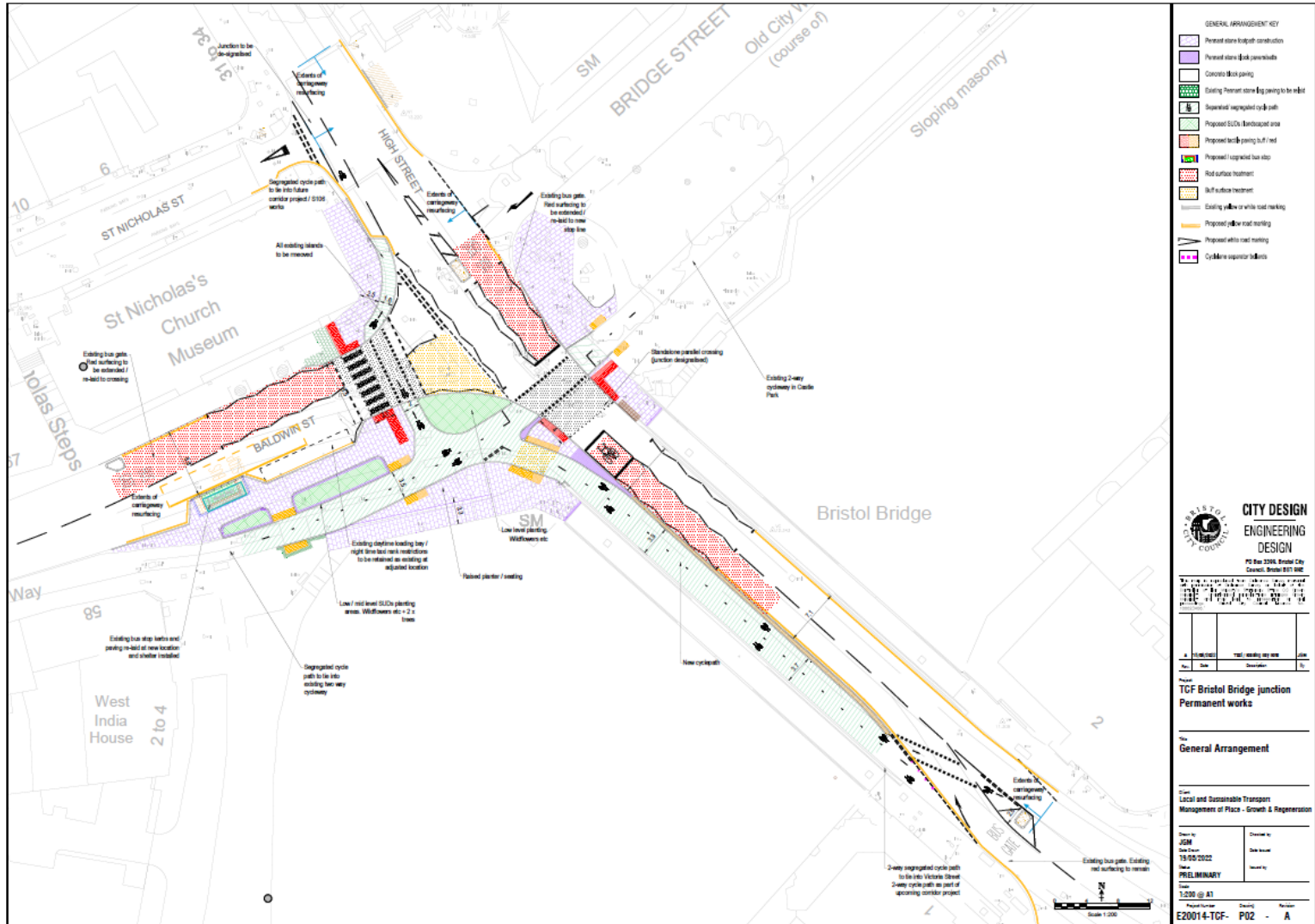

Victoria Street – proposed changes



Old City / King St

- Bollards currently in place to prevent access, looking to upgrade with barriers and ANPR
- Civil works start later this year
- Package of walking and cycling improvements



W&C Schemes

- Old Market Gap
- Cotham Hill
- Park Row/Upper Maudlin St



East Bristol Liveable Neighbourhood

Liveable Neighbourhood project area



JLTP 4 Mass Transit Corridors

